

# Lodi Township Vacant Land Sales Map 2024

- Sales Price
- 35,000 - 53,000
  - 53,000 - 130,000
  - 130,000 - 200,000
  - 200,000 - 335,000
  - 335,000 - 495,000

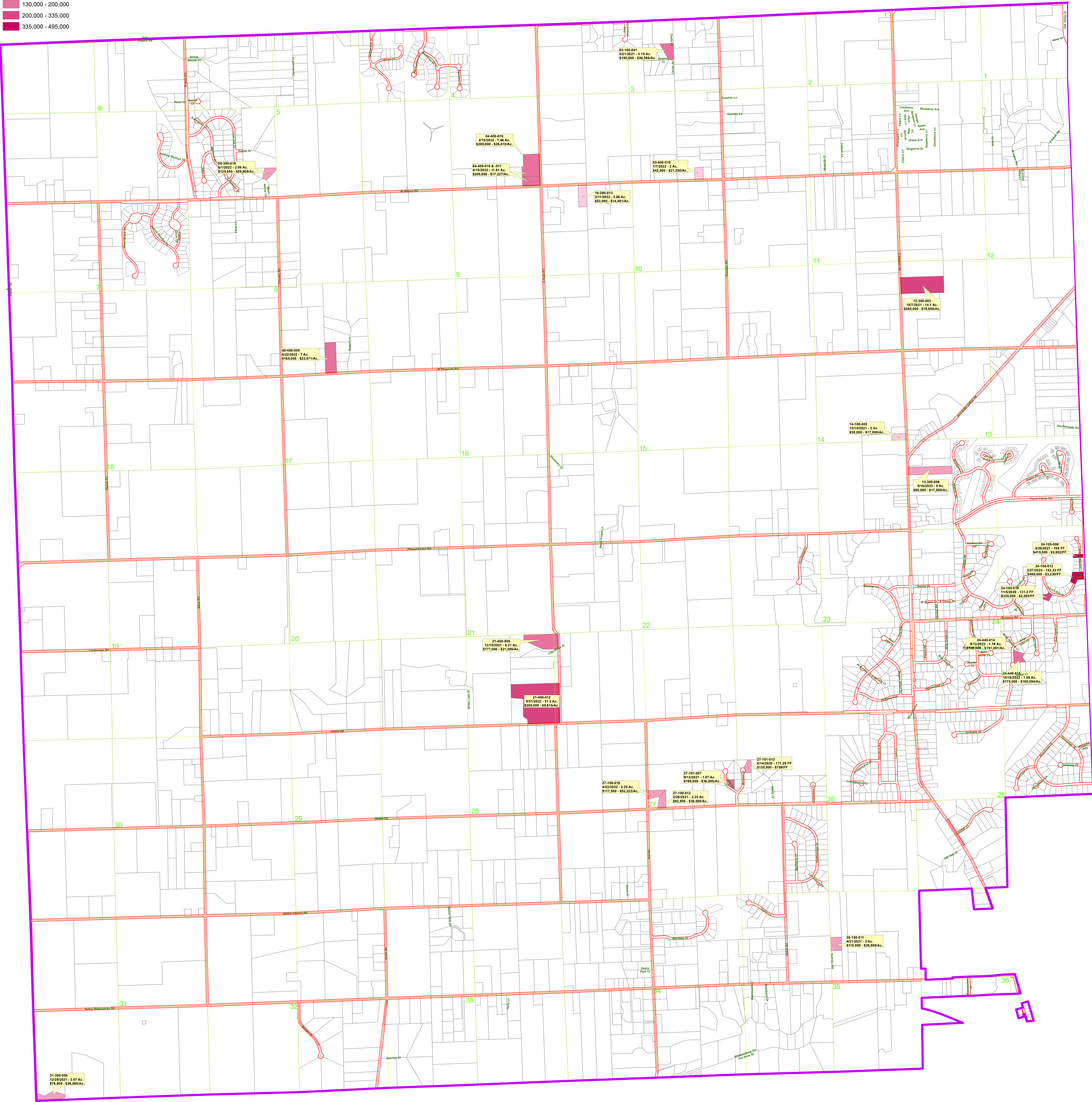

- Jurisdiction Boundary
- Section Line
- Quarter Section Line
- Parcels



N

The information contained in this cadastral map is used to locate, identify and inventory parcels of land in Washtenaw County for appraisal and taxing purposes only and is not to be construed as a "survey description". The information is provided with the understanding that the conclusions drawn from such information are solely the responsibility of the user. Any assumption of legal status of this data is hereby disclaimed.

NOTE: PARCELS MAY NOT BE TO SCALE

